

R/A FEMALE MODULE 4 SOLDER TYPE INSERTS

SOLDER TYPE 4.5MM C50

R694.252.175

Series : MCC2

4 COAX POSITION AB/1B, 1C

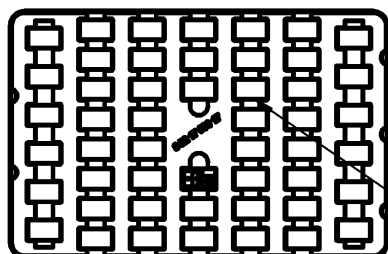
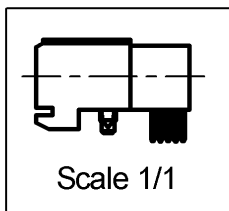
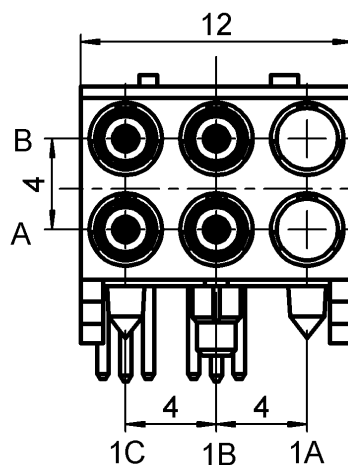
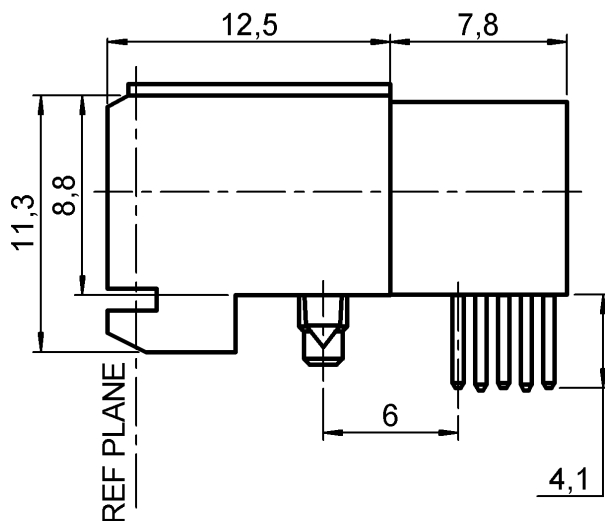

Connectors' packaging
Tray+sleeve+box

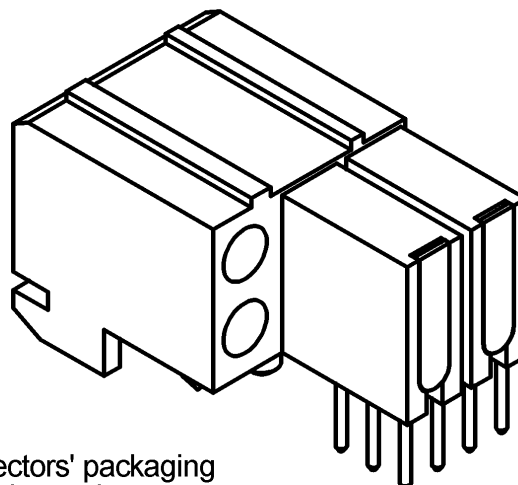

All dimensions are in mm.

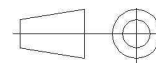

COMPONENTS	MATERIALS	PLATING (μm)
BODY	BRASS	NPGR
CENTER CONTACT	BERYLLIUM COPPER	NPGR
OUTER CONTACT	-	-
INSULATOR	PEEK , ULTEM	-
GASKET	-	-
OTHERS PARTS	BRASS	NICKEL 2
-	-	-
-	-	-

Issue : 0632 G

In the effort to improve our products, we reserve the right to make changes judged to be necessary.



R/A FEMALE MODULE 4 SOLDER TYPE INSERTS**R694.252.175****SOLDER TYPE 4.5MM C50**

Series : MCC2

PACKAGING

Standard	Unit	Other
50	'W' option	Contact us

SPECIFICATION**ELECTRICAL CHARACTERISTICS**

Impedance	50	Ω
Frequency	0-6	GHz
VSWR	1.15* + 0,0000	x F(GHz) Maxi
Insertion loss	0.2**	$\sqrt{F}(\text{GHz})$ dB Maxi
RF leakage	- (30)	- F(GHz)) dB Maxi
Voltage rating	500	Veff Maxi
Dielectric withstanding voltage	750	Veff mini
Insulation resistance	5000	M Ω mini

ENVIRONMENTAL

Operating temperature	-25/+125	$^{\circ}\text{C}$
Hermetic seal	NA	Atm.cm3/s
Panel leakage	NA	

OTHER CHARACTERISTICS

Assembly instruction

Others :

*VSWR optimized between DC to 3GHz

**DC-3GHz

MECHANICAL CHARACTERISTICS

Center contact retention	
Axial force – Mating end	6 N mini
Axial force – Opposite end	6 N mini
Torque	NA N.cm mini
Recommended torque	
Mating	NA N.cm
Panel nut	NA N.cm
Mating life	500 Cycles mini
Weight	90,5900 g

Issue : 0632 G

In the effort to improve our products, we reserve the right to make changes judged to be necessary.

**RADIALL®**

RADIALL®

R/A FEMALE MODULE 4 SOLDER TYPE INSERTS**R694.252.175****SOLDER TYPE 4.5MM C50**

Series : MCC2

- Place the coax connector(s) on the PCB

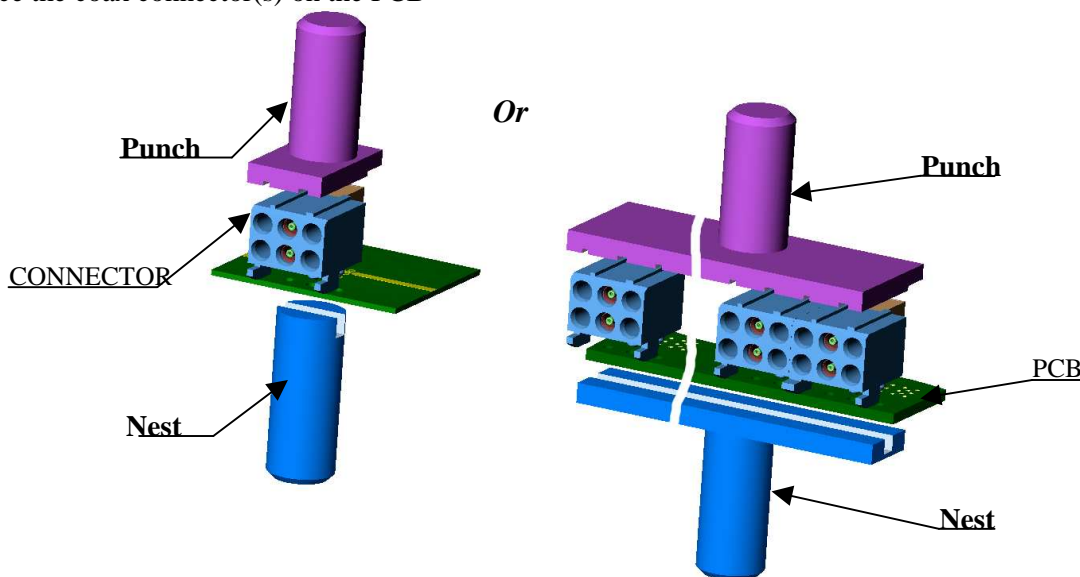

- Place correctly the PCB between the punch and the nest of the press.
- In case of multiple housing configuration, use a punch and a nest large enough to cover all the housings.
- Press on the plastic housing(s) with the punch until the complete insertion of the fixing stud into the PCB.

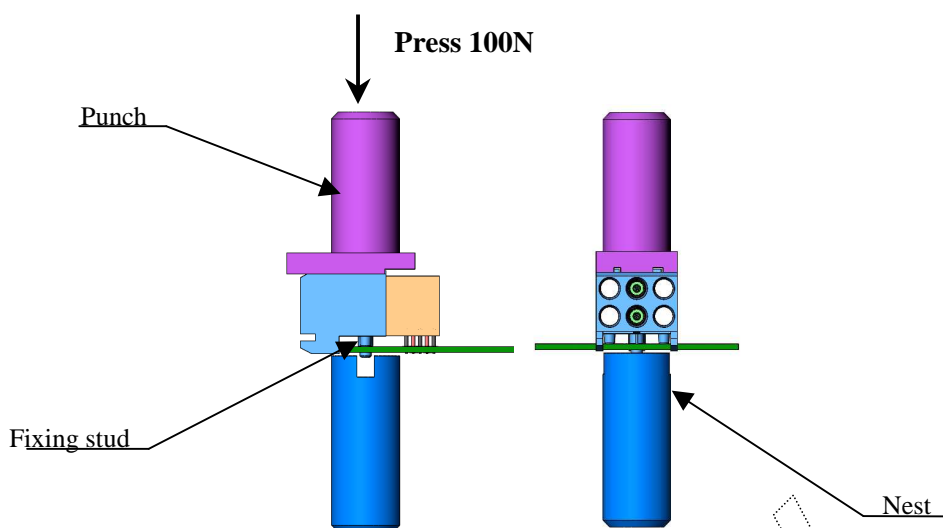

- Solder the legs on board

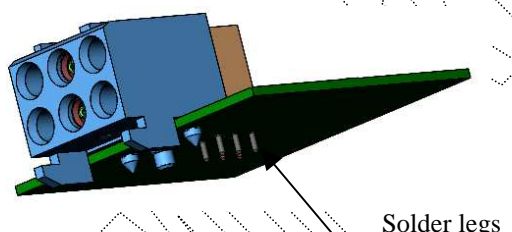

Radiall do not recommend to use more than 3 modules on the same motherboard and can't be held liable of any connection defect when more than 3 modules are implemented on the board.

Issue : 0632 G

In the effort to improve our products, we reserve the right to make changes judged to be necessary.

