

**STRAIGHT PLUG SOLDER TYPE
WITH COMPOUND CHAMBER
FOR CABLE SHF 8+8M**

M163.068.L04

Series : N-18

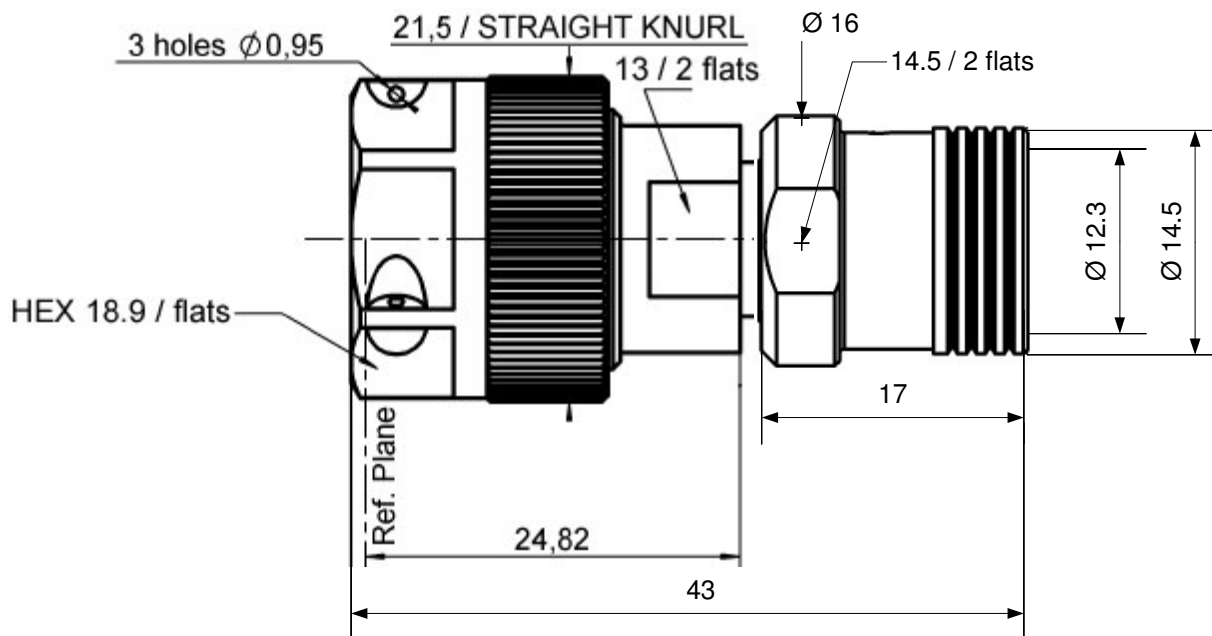

All dimensions are in mm.

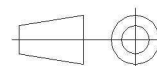

COMPONENTS	MATERIALS	PLATING (μm)
BODY	STAINLESS STEEL (316L)	PASSIVATED
CENTER CONTACT	BRASS	GOLD 1.3 OVER NICKEL 2
OUTER CONTACT		
INSULATOR	PTFE	
GASKET	FLUOROSILICON	
OTHERS PARTS	ST. STEEL (316L) , BRASS	GOLD , PASSIVATED
-		
-		

Issue : 0609 A

In the effort to improve our products, we reserve the right to make changes judged to be necessary.



RADIALL®

**STRAIGHT PLUG SOLDER TYPE
WITH COMPOUND CHAMBER
FOR CABLE SHF 8+8M**

M163.068.L04

Series : N-18

PACKAGING

Standard	Unit	Other
1	-	Contact us

ELECTRICAL CHARACTERISTICS

Impedance	50	Ω
Frequency	0-18	GHz
VSWR	1.12 + 0,0000	x F(GHz) Maxi
Insertion loss	0.1	$\sqrt{F}(\text{GHz})$ dB Maxi
RF leakage	- (90)	- F(GHz)) dB Maxi
Voltage rating	500	Veff Maxi
Dielectric withstanding voltage	1500	Veff mini
Insulation resistance	5000	M Ω mini

MECHANICAL CHARACTERISTICS

Center contact retention	
Axial force – Mating end	27 N mini
Axial force – Opposite end	27 N mini
Torque	NA N.cm mini

Recommended torque	
Mating	400 N.cm
Panel nut	NA N.cm
Clamp nut	300 N.cm
A/F clamp nut	11,0000 mm

Mating life	500 Cycles mini
Weight	46,2780 g

ENVIRONMENTAL

Operating temperature	-65/+165 °C
Hermetic seal	NA Atm.cm3/s
Panel leakage	IP67

SPECIFICATION

CABLE ASSEMBLY

Stripping	a	b	c	d	e	f
mm	19,0	3,00	0,00	0,00	0,00	0,00

Assembly instruction :

Recommended cable(s)
F1703-160
F1703-197

Characteristics indicated on this data sheet are those that can be achieved with the highest performance cable. Intrinsic limitations of the cable may diminish the performance of the assembly

Cable retention

- pull off	* N mini
- torque	NA N.cm

TOOLING

Part Number	Description	Hexagon
.	.	.

OTHER CHARACTERISTICS

* See the TDS cable assembly

Issue : 0609 A

In the effort to improve our products, we reserve the right to make changes judged to be necessary.



RADIALL®