

PAGE 1/2	ISSUE 04-01-16C	SERIES RXF	PART NUMBER RXF2131700
----------	-----------------	------------	------------------------

Dimensions in mm

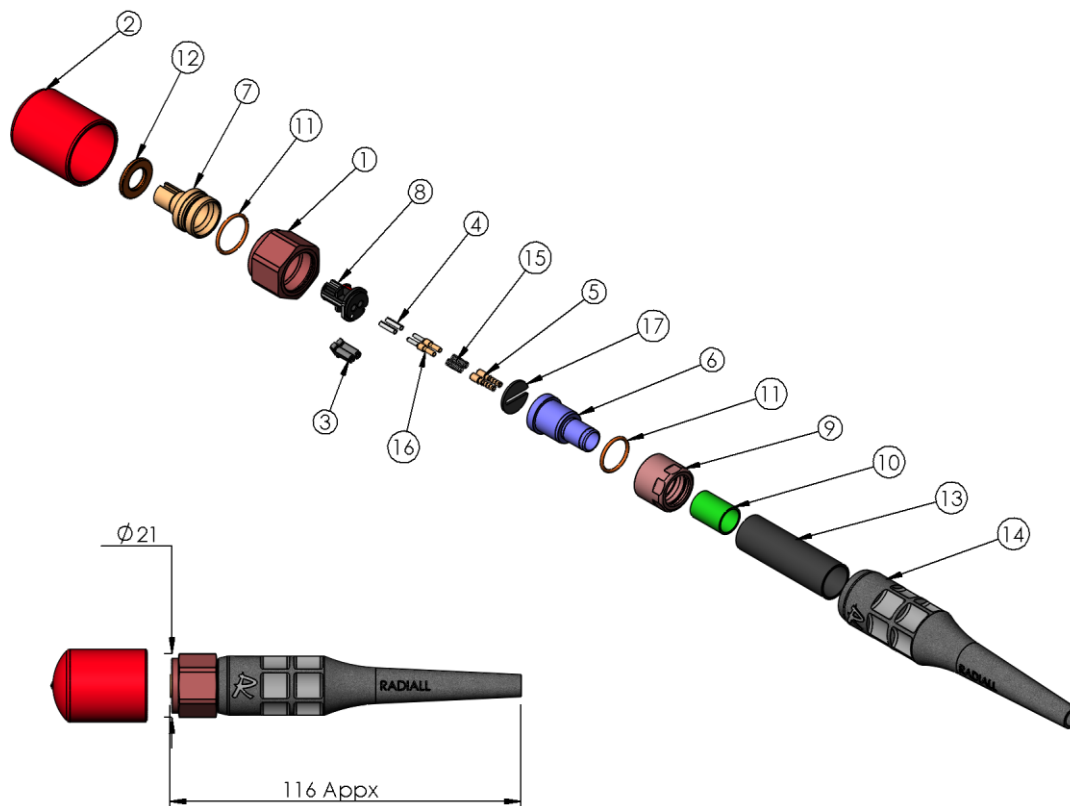

DESCRIPTION

REP	COMPONENT	Part No.	MATERIAL	PLATING	Qty.
1	RXF locking nut		Brass	Nickel	1
2	Vinyl red cap		Soft vinyl	NA	1
3	Ferrule Caps		H.D.P.E	NA	2
4	Sleeve	F042360010	Ceramic	NA	2
5	Contact Crimp Rear Tube	F076461663	Brass	Nickel	2
6	Plug Crimp Neck	F076461643	Brass	Nickel	1
7	RXF Plug body		Brass	Nickel	1
8	R2F Insert	F043043070	IXEF	NA	1
9	Nut M14 x 0.5		Brass	Nickel	1
10	Ferrule	F052310063	Brass	Nickel	1
11	O-Ring		Silicone Rubber	NA	2
12	Flat Gasket		Silicone Rubber	NA	1
13	Heat Shrink Sleeve		-	NA	1
14	Boot		Tefabloc	NA	1
15	Spring	F083300120	Stainless Steel	NA	2
16	S/A Ferrule holder + SM Ferrule	F086643060	-	NA	2
17	Contact arrester		Stainless Steel	NA	1

PAGE 2/2	ISSUE 04-01-16C	SERIES RXF	PART NUMBER RXF2131700
----------	------------------------	-------------------	-------------------------------

Dimensions in mm

GENERAL CHARACTERISTICS

Material	Connector metallic parts	Brass
	Plating	Nickel, underplating Copper
	Connector plastic part	PAA 50% glass fiber
	Ferrule	Ceramic
	Seal	Silicone rubber

Mechanical	Tensile load IEC 61300-2-4	800N max
	Static side load IEC 61300-2-42	30N max
	Vibration IEC 61300-2-1	10-500Hz / 10g passed
	Bump IEC 61300-2-9	40g passed
	Mating endurance	500 cycles
	Type N shape and thread	Compliant
	Mating Torque	1 N.m Recommended (5N.m Max)

Environmental	Operational temperature	-40/+85°C
	Storage temperature	-55/+85°C
	Humidity (damp heat)	95% HR
	Salt mist IEC 61300-2-26	Passed
	Protection class IEC 60529	IP68 when coupled or with threaded cap
	RoHS	Compliant

Optical	Insertion Loss (typical – max)	Single mode, @ 1310nm = 0.2 dB Typ 0.5 dB max
	Return Loss (typical)	>50 dB

Packaging	100 pieces, each component in plastic bag or tray, all in cardboard box.
Piece part MOQ	100 pieces

CABLING PROCESS

Following RADIALl Cabling Instructions of R2F Plug with the use of the specific toolings list is recommended.