

PAGE 1/2	ISSUE 11-12-15C	SERIES RXF	PART NUMBER <b>RXF2131510</b>
----------	-----------------	------------	-------------------------------

Dimensions in mm

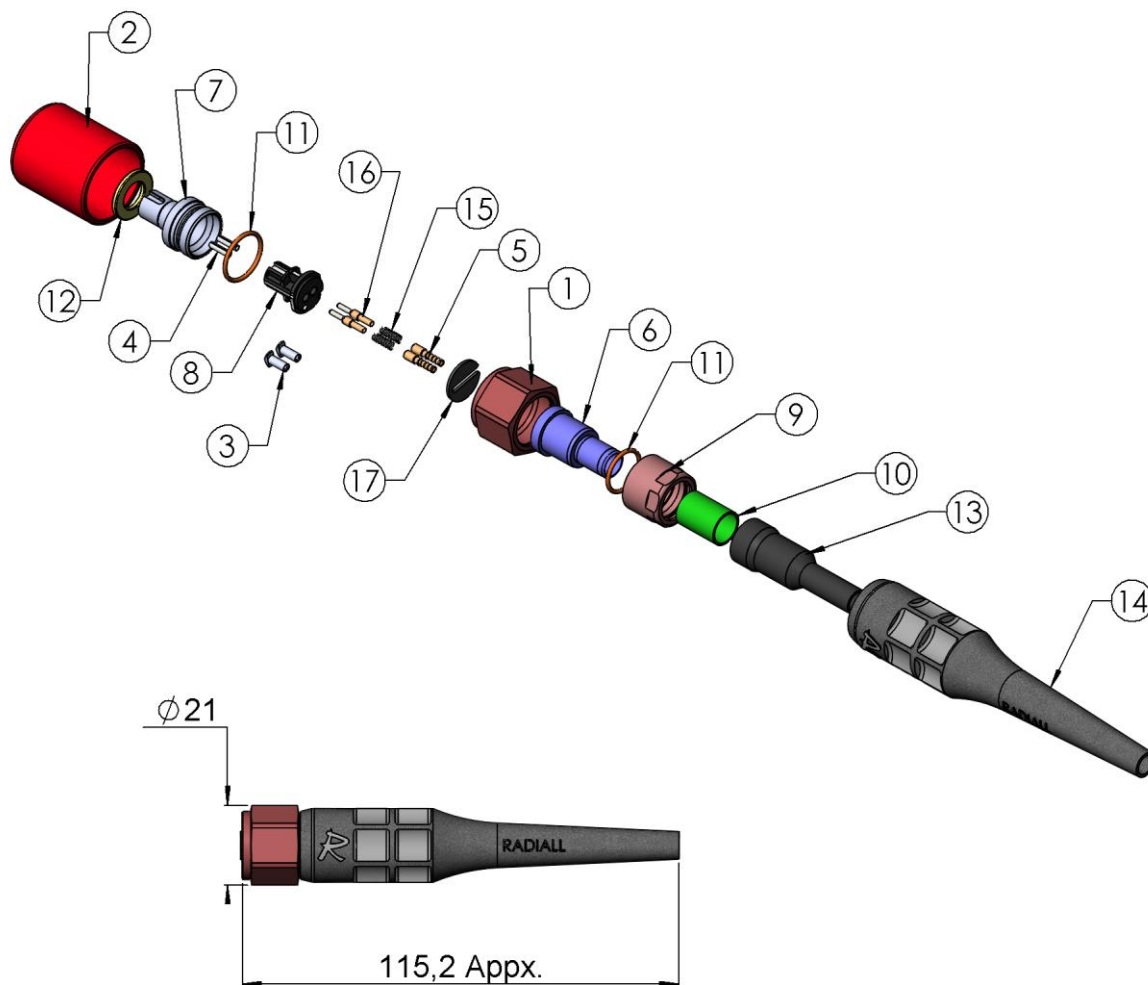

## DESCRIPTION

REP	COMPONENT	Part No.	MATERIAL	PLATING	Qty.
1	Locking nut		Brass	Nickel	1
2	Vinyl red cap		Soft vinyl	NA	1
3	Ferrule Caps		H.D.P.E	NA	2
4	Sleeve	F042360010	Ceramic	NA	2
5	Contact Crimp Rear Tube	F076461663	Brass	Nickel	2
6	Plug Crimp Neck		Brass	Nickel	1
7	RXF Plug body		Brass	Nickel	1
8	R2F Insert	F043043070	IXEF	NA	1
9	Nut M14 x 0.5		Brass	Nickel	1
10	Ferrule	F052310033	Brass	Nickel	1
11	O-Ring		Silicone Rubber	NA	2
12	Flat Gasket		Red Silicone Rubber	NA	1
13	Heat Shrink Sleeve		-	NA	1
14	Boot		Tefabloc	NA	1
15	Spring		Steel	NA	2
16	S/A Ferrule holder + SM Ferrule	F086643060	-	NA	2

PAGE 2/2	ISSUE 11-12-15C	SERIES RXF	PART NUMBER RXF2131510
----------	-----------------	------------	------------------------

Dimensions in mm

## GENERAL CHARACTERISTICS

<b>Material</b>	Connector metallic parts	Brass
	Plating	Nickel, underplating Copper
	Connector plastic part	PAA 50% glass fiber
	Ferrule	Ceramic
	Seal	Silicone rubber

<b>Mechanical</b>	Tensile load IEC 61300-2-4	800N max
	Static side load IEC 61300-2-42	30N max
	Vibration IEC 61300-2-1	10-500Hz / 10g passed1
	Bump IEC 61300-2-9	40g passed
	Mating endurance	500 cycles
	Type N shape and thread	Compliant
	Mating torque	1 N.m Recommended (5 N.m Max)

<b>Environmental</b>	Operational temperature	-40/+85°C
	Storage temperature	-55/+85°C
	Humidity (damp heat)	95% HR
	Salt mist IEC 61300-2-26	Passed
	Protection class IEC 60529	IP68 when coupled or with threaded cap
	RoHS	Compliant

<b>Optical</b>	Insertion Loss (typical – max)	Single mode, @1310nm = 0.2 dB Typ 0.5 dB max
	Return Loss	>50 dB

<b>Packaging</b>	100 pieces of each component in plastic bag or tray, all in cardboard box.
<b>Piece part MOQ</b>	100 pieces

<b>Other</b>	<b>Custom design :</b> - Interface flat gasket thickness : 1.5 mm - Interface locking nut overall length : 14 mm
--------------	--

## CABLING PROCESS

Following RADIALl Cabling Instructions of R2F Plug with the use of the specific toolings list is recommended.