

PAGE 1/2

ISSUE  
**19-12-23C**

SERIES  
**DETECTOR**

PART NUMBER **R451534000**

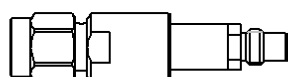
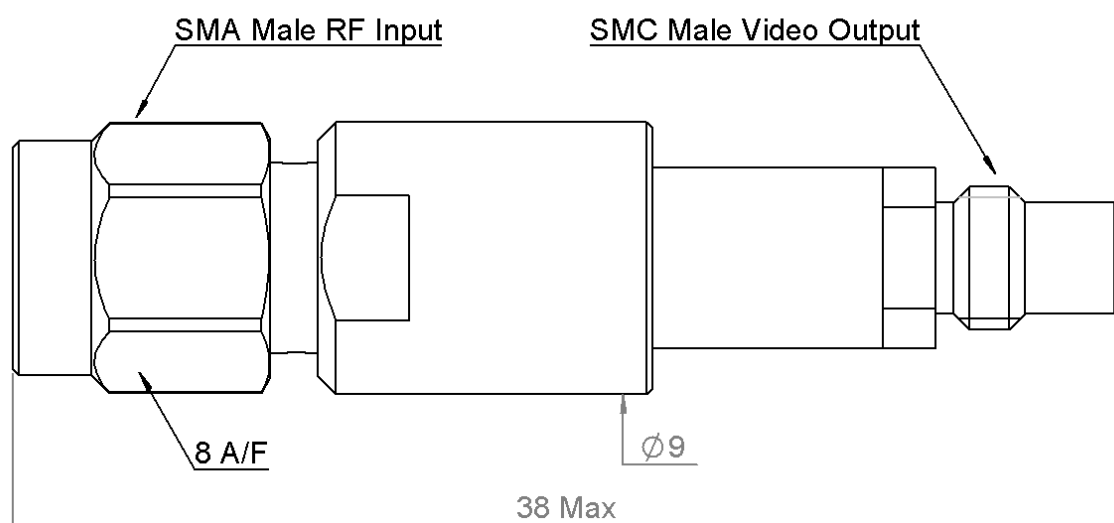

SCALE 1:1

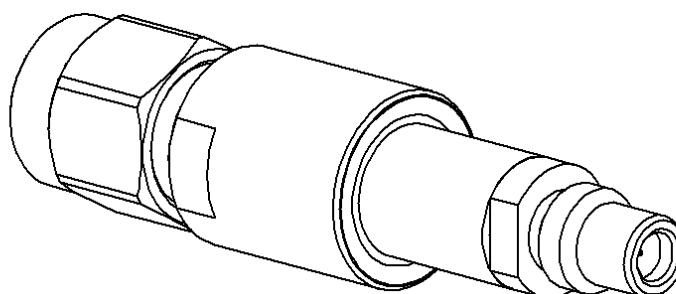

All dimensions are in mm. Tolerances according ISO 2768 c-K

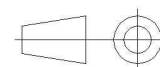

Weight (±15%) **8,8400 g**  
Specification

PAGE 2/2

 ISSUE  
**19-12-23C**

 SERIES  
**DETECTOR**

 PART NUMBER **R451534000**

### ELECTRICAL CHARACTERISTICS

|  |                                 |
|--|---------------------------------|
| FREQUENCY RANGE (GHz)                                | 0.01 – 18                       |
| IMPEDANCE  | 50 Ohms                         |
| SENSITIVITY LEVEL (Input Power <= -20 dBm)           | > 500 mV / mW                   |
| FREQUENCY RESPONSE<br><br>0.01 – 2 GHz<br>2 – 18 GHz | <br>± 0.5 dB / octave<br>± 1 dB |
| VSWR<br><br>0.01 – 8 GHz<br>8 – 18 GHz               | <br><= 1.35<br><= 1.50          |
| AVERAGE POWER  | 200 mW at 25°C                  |
| PEAK POWER   | 2W (10 nS , 1mS)                |
| OUTPUT POLARITY                                      | Negative                        |
| FILTERING CAPACITY (Typical)                         | 20 pF                           |
| DIODE  | Schottky "Zero Bias"            |

### MECHANICAL CHARACTERISTICS

|                        |                          |
|------------------------|--------------------------|
| RF INPUT CONNECTOR     | SMA Male Per MIL C 39012 |
| VIDEO OUTPUT CONNECTOR | SMC Male Per MIL C 39012 |

### ENVIRONMENTAL CHARACTERISTICS

|                                  |            |
|----------------------------------|------------|
| OPERATING TEMPERATURE RANGE (°C) | - 25 / +70 |
| STORAGE TEMPERATURE RANGE (°C)   | - 40 / +85 |