

PAGE 1/2	ISSUE 19-04-24A	SERIES DC BLOCK	PART NUMBER <b>R443131000</b>
----------	--------------------	--------------------	-------------------------------

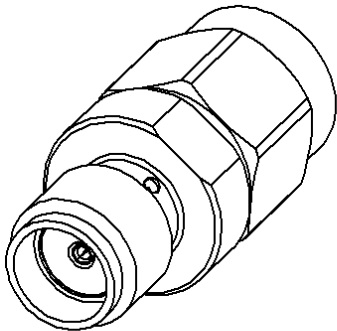

All dimensions are in mm. Tolerances according ISO 2768 c-K

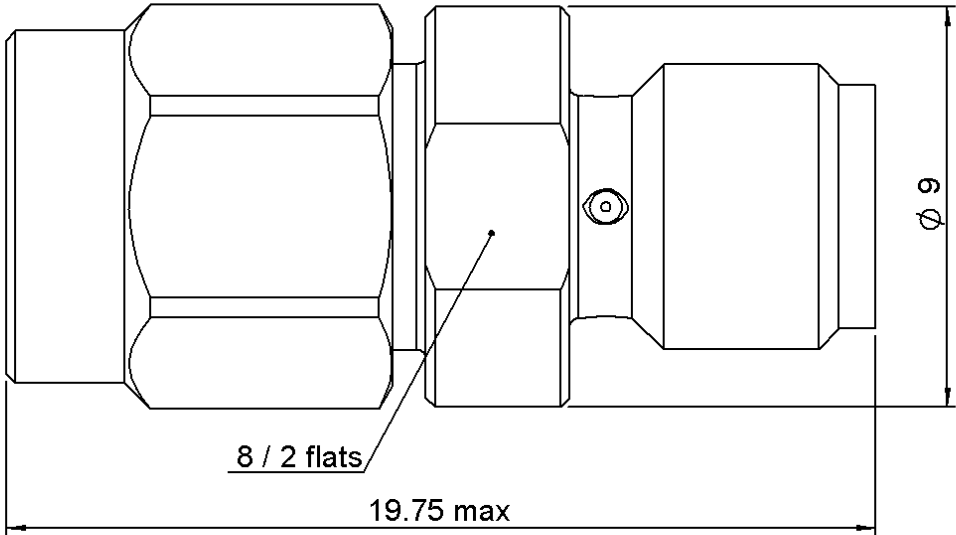
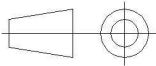

Weight (±15%) **4,2500 g**  
Specification

COMPONENTS	MATERIALS	PLATING (µm)
Body	<b>BRASS</b>	<b>NICKEL 2</b>
Male center contact	<b>BRASS</b>	<b>GOLD 0.5 OVER NICKEL 2</b>
Female center contact	<b>BERYLLIUM COPPER</b>	<b>GOLD 0.5 OVER NICKEL 2</b>
Outer contact		
Insulator	<b>PTFE</b>	
Gasket	<b>SILICONE RUBBER</b>	
Substrate		
Resistor		
Others parts		

PAGE 2/2

ISSUE  
19-04-24A

SERIES  
DC BLOCK

PART NUMBER **R443131000**

## ELECTRICAL CHARACTERISTICS

Frequency (GHz)	<b>0.01 - 3</b>	<b>3 - 6</b>
V.S.W.R ( $\leq$ )	<b>1.20</b>	<b>1.40</b>
Deviation( $\pm$ dB)	<b>0.30</b>	<b>0.60</b>

Operating Frequency Range	<b>0.01 - 6</b>	GHz
Impedance	<b>50</b>	$\Omega$
Main line voltage	<b>60</b>	V
Typical capacitance	<b>4700</b>	pF
Average power at 25°C	<b>10</b>	W (Free Air Cooled)
		W (Conduction Cooled)

## MECHANICAL CHARACTERISTICS

Connectors	<b>SMA</b>	<b>Male Female</b>	<b>MIL C39012</b>
------------	------------	--------------------	-------------------

## ENVIRONMENTAL CHARACTERISTICS

Operating temperature range	<b>-40/+85</b> °C
Storage temperature range	<b>-40/+85</b> °C

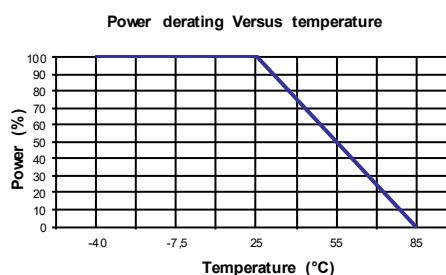

## SPECIFICATION

## OTHER CHARACTERISTICS