

PAGE 1/2	ISSUE 29-03-24A	SERIES FILTER	PART NUMBER R438538101
----------	--------------------	---------------	------------------------

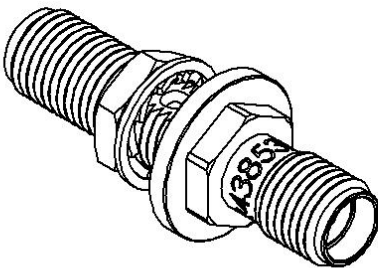

All dimensions are in mm. Tolerances according ISO 2768 c-K

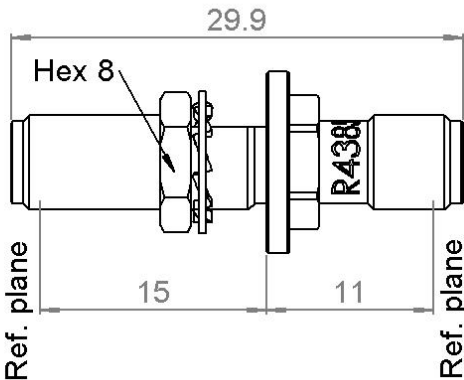
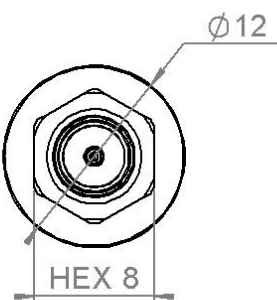
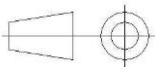

Weight (±15%) 7,0000 g
Specification

COMPONENTS	MATERIALS	PLATING (µm)
Body	COPPER Cu-ETP	GOLD OVER COPPER
Center contact	BERYLLIUM COPPER	GOLD OVER COPPER
Insulator	PTFE	
Absorber	ECCOSORB	
Others parts		-

PAGE 2/2

 ISSUE
29-03-24A

 SERIES **FILTER**

 PART NUMBER **R438538101**

ELECTRICAL CHARACTERISTICS

Operating Frequency Range	DC - 15	GHz
Impedance	50	Ω
Return loss :		
0 – 8GHz	18	dB min
8 – 15GHz	15	dB min
Insertion loss :		
DC – 5GHz	0.6 Linear increase after 5 GHz	dB max

MECHANICAL CHARACTERISTICS

Connectors	SMA	Female – Female	MIL C39012 for dimensions
------------	------------	------------------------	----------------------------------

Connector torque	40 ±5	N.cm
Mechanical interface durability	100	cycles

ENVIRONMENTAL CHARACTERISTICS

Operating temperature range	0.01 – 350	K
Storage temperature range	-55/+125	°C

OTHER CHARACTERISTICS

For Cryogenic applications
Thermalization through flange