

PAGE 1/2	ISSUE 26-02-24A	SERIES ATTENUATOR	PART NUMBER <b>R429800000</b>
----------	--------------------	----------------------	-------------------------------

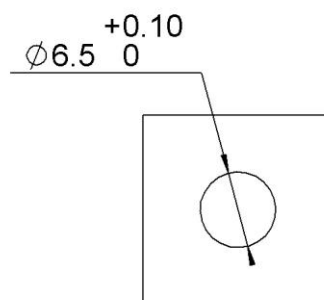

Panel cutout  
Panel thickness : 10 max.  
3 min.

All dimensions are in mm. Tolerances according ISO 2768 c-K

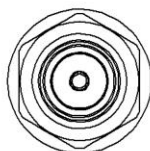
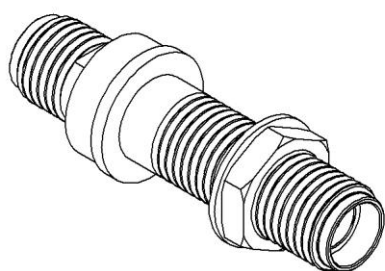
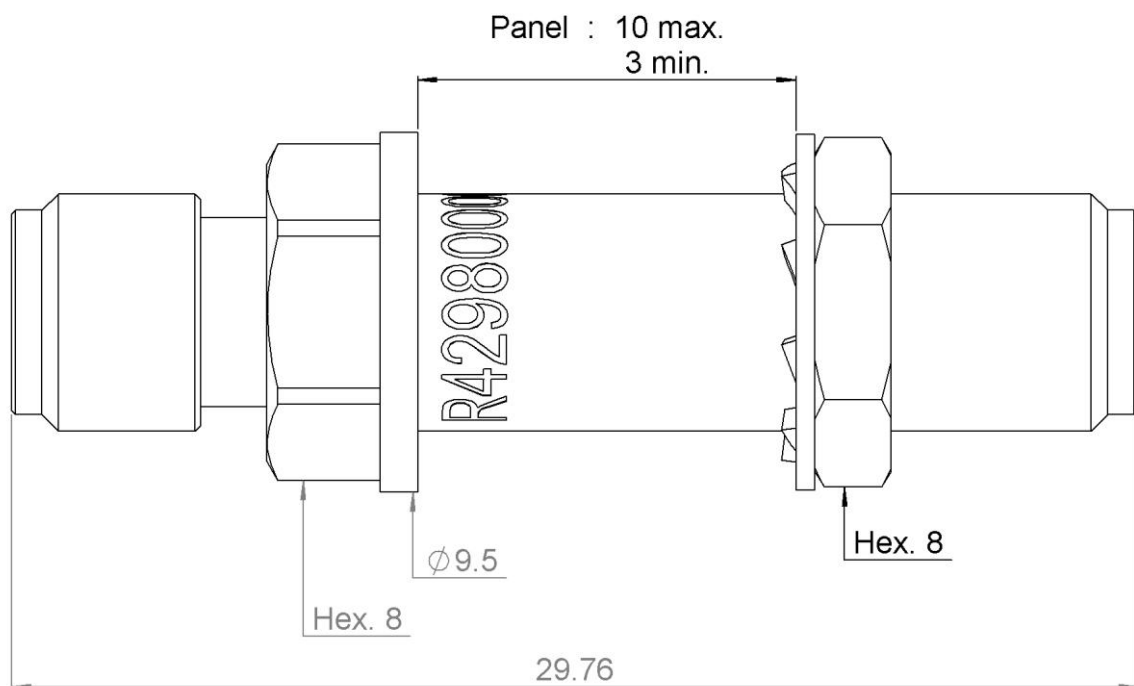
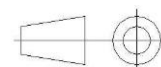

COMPONENTS	MATERIALS	PLATING (µm)
Body	<b>BRASS.</b>	<b>BBR</b>
Male center contact		
Female center contact	<b>BERYLIUM COPPER</b>	<b>GOLD OVER NICKEL</b>
Outer contact		
Insulator	<b>PTFE</b>	
Gasket	<b>SILICONE RUBBER</b>	
Substrate	<b>ALUMINIUM NITRIDE</b>	
Resistor	<b>THIN FILM</b>	
Others parts		

PAGE 2/2	ISSUE 26-02-24A	SERIES ATTENUATOR	PART NUMBER <b>R429800000</b>
----------	--------------------	----------------------	-------------------------------

## ELECTRICAL CHARACTERISTICS

Frequency (GHz)	<b>DC-8</b>	<b>8-12.4</b>	<b>12.4-18</b>
V.S.W.R ( $\leq$ )	<b>1.2</b>	<b>1.25</b>	<b>1.35</b>
Deviation( $\pm$ dB)	<b>0.3</b>	<b>0.3</b>	<b>0.3</b>

Operating Frequency Range	<b>DC - 18</b>	GHz
Impedance	<b>50</b>	$\Omega$
Nominal Attenuation	<b>0</b>	dB
Peak power at 25°C (1 $\mu$ s, 1%)	<b>100</b>	W
Average power at 25°C	<b>2</b>	W (Free Air Cooled)
		W (Conduction Cooled)

## MECHANICAL CHARACTERISTICS

Connectors	<b>SMA</b>	<b>Female Female</b>	<b>MIL C39012</b>
Weight ( $\pm$ 15%)	<b>6,6900</b>	g	

## ENVIRONMENTAL CHARACTERISTICS

Operating temperature range	<b>0.01/400</b>	K
Storage temperature range	<b>-55/125</b>	°C

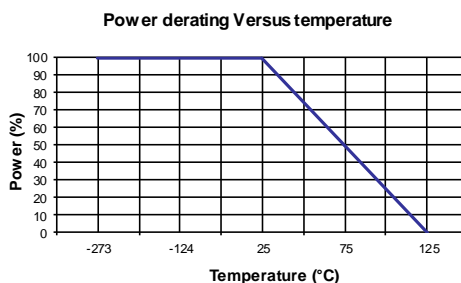

## SPECIFICATION

## OTHER CHARACTERISTICS