

| | | | |
|----------|--------------------|----------------------|------------------------|
| PAGE 1/2 | ISSUE 12-05-25B | SERIES ATTENUATOR | PART NUMBER R417030130 |
|----------|--------------------|----------------------|------------------------|

SCALE 1 : 2

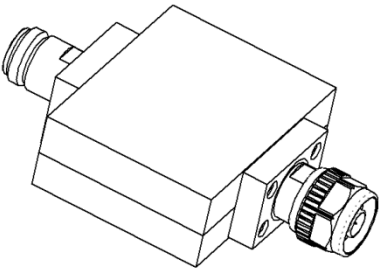

All dimensions are in mm. Tolerances according ISO 2768 c-K

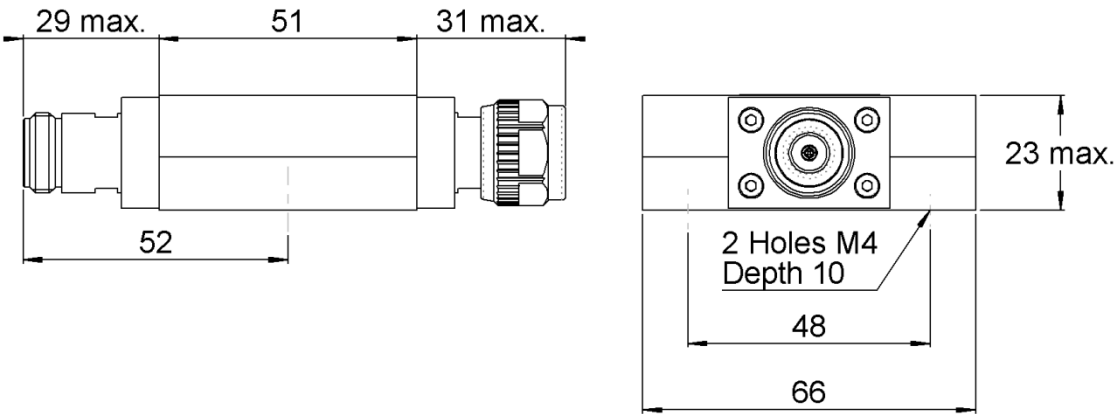
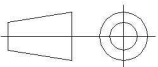

| COMPONENTS | MATERIALS | PLATING (µm) |
|-----------------------|----------------------------|--|
| Body | STAINLESS STEEL | PASSIVATED. |
| Male center contact | BERYLLIUM COPPER | GOLD 0.5 OVER NICKEL PHOSPHORUS 2 |
| Female center contact | BERYLLIUM COPPER | GOLD 0.5 OVER NICKEL PHOSPHORUS 2 |
| Outer contact | | |
| Insulator | PTFE | |
| Gasket | ELASTOMERE SILICONE | |
| Substrate | ALUMINA | |
| Resistor | THICK FILM | |
| Others parts | ALUMINIUM | BLACK PAINTING |

PAGE 2/2

 ISSUE
12-05-25B

 SERIES
ATTENUATOR

 PART NUMBER **R417030130**

ELECTRICAL CHARACTERISTICS

| | | | |
|----------------------|---------------|--------------|--------------|
| Frequency (GHz) | DC - 1 | 1 - 2 | 2 - 3 |
| V.S.W.R (\leq) | 1.10 | 1.25 | 1.35 |
| Deviation(\pm dB) | 2.00 | 2.00 | 2.00 |

| | | |
|---|---------------|-----------------------|
| Operating Frequency Range | DC - 3 | GHz |
| Impedance | 50 | Ω |
| Nominal Attenuation | 30 | dB |
| Peak power at 25°C (1 μ s, 1%) | 5000 | W |
| Average power at 25°C | | W (Free Air Cooled) |
| | 50 | W (Conduction Cooled) |
| For conduction cooling, a plate 500 cm² x 3 mm(78 sq.in*1/8) min. is required | | |

MECHANICAL CHARACTERISTICS

| | | | |
|---------------------|-----------------|--------------------|--------------------|
| Connectors | N | Male Female | MIL-C 39012 |
| Weight (\pm 15%) | 290,4100 | g | |

ENVIRONMENTAL CHARACTERISTICS

| | | |
|-----------------------------|------------------|----|
| Operating temperature range | -55 /+125 | °C |
| Storage temperature range | -55 /+125 | °C |

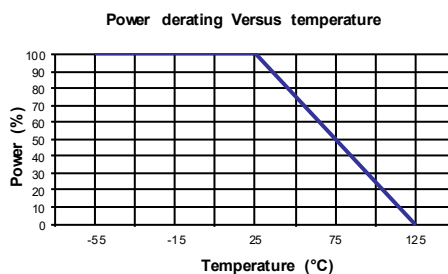

SPECIFICATION

OTHER CHARACTERISTICS