 <b>RADIAL</b> ®	<b>WIRING INSTRUCTIONS</b>	<b>MI CT 01 00031</b>		
Series NSX	SIZE 1 COAXIAL CONTACT (620103 AND 620003) FOR RG142 CABLE AND NGC875BAR-1 CABLE		Issue Sept. 07, 2011	Page 1 / 2

STEP 1/  
TRIM CABLE TO DIMENSIONS SHOWN ABOVE.

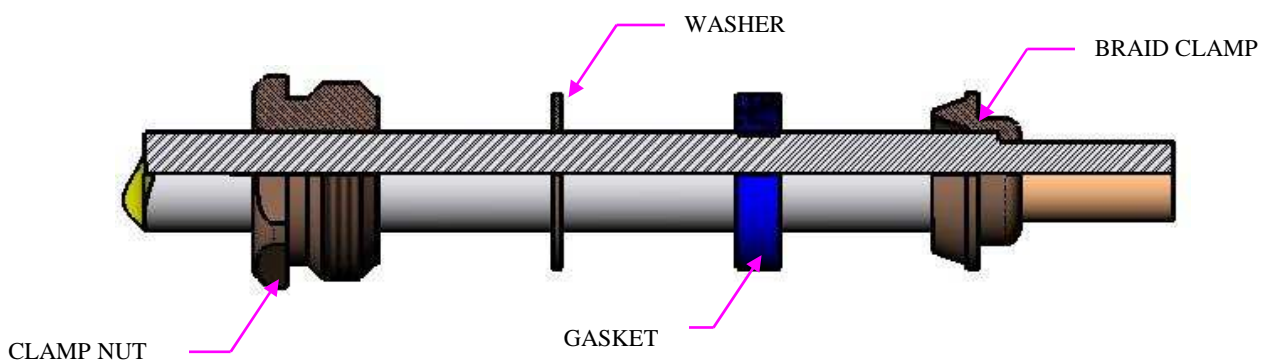

	A
FOR 620003 (PIN)	18.75 / 17.50 (.738 / .689)
FOR 620103 (SOCKET)	11.25 / 10.00 (.443 / .394)

STEP 2/  
SLIDE CLAMP NUT, WASHER AND GASKET OVER OUTER JACKET.  
NEXT SLIDE BRAID CLAMP UNTIL IT BUTTS UP AGAINST OUTER JACKET.



STEP 3/  
COMB BRAID UNTIL ALL STRANDS ARE STRAIGHT.  
NEXT FOLD BRAID BACK OVER BRAID CLAMP AS SHOWN.

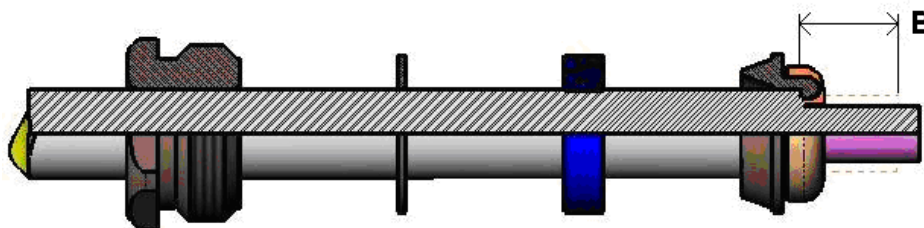

	B
FOR 620003 (PIN)	6.35 / 5.35 (.250 / .211)
FOR 620103 (SOCKET)	6.35 / 5.35 (.250 / .211)

<b>CREATION</b> NAME : MOUTAULT DATE: JUNE. 06, 2011 APPR. : BROCHET				
	Sept. 07, 11	Add NGC875BAR-1 cable and size 1 coaxial cts (620003)	Moutault	Dupuis
	<b>ISSUE</b>	<b>REVISIONS</b>	<b>NAME</b>	<b>APPROVED</b>

MICT0100031EN

**STEP 4/**

SLIDE BUSHING OVER DIELECTRIC UNTIL IT STOPS AGAINST BRAID.  
TRIM DIELECTRIC AS SHOWN.  
TRIM INNER CONDUCTOR TO DIMENSION SHOWN.

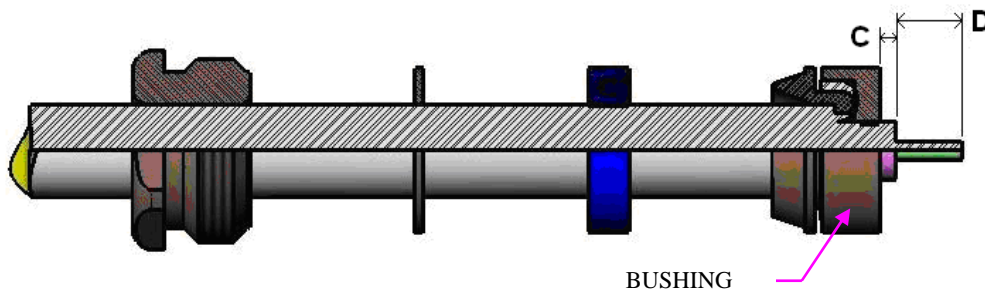

	C	D
FOR 620003 (PIN)	1.05 / 0.90 (.041 / .035)	11.60 / 11.35 (.457 / .448)
FOR 620103 (SOCKET)	1.05 / 0.90 (.041 / .035)	4.10 / 3.85 (.161 / .152)

**STEP 5/**

ASSEMBLE INSULATOR WASHER AND CENTRAL CONTACT OVER INNER CONDUCTOR UNTIL INSULATOR WASHER STOPS AGAINST BUSHING.  
SLIDE CENTER SOCKET OR PIN CONTACT OVER SOLID SILVER PLATED COPPER THEN SOLDER AS SHOWN.

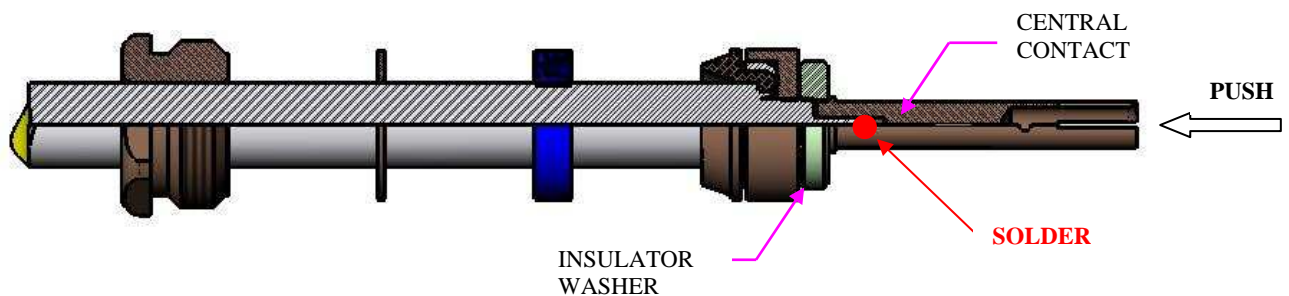

\*Picture above represents socket center contact for display only.

**STEP 6/**

INSERT CONTACT / CABLE ASSEMBLY INTO BODY ASSY, SLIDE BUSHING, BRAID CLAMP, GASKET AND WASHER INTO BODY ASSY.  
SCREW CLAMP NUT IN PLACE AND TIGHTEN USING 45 TO 55 INCH POUNDS TORQUE (5 TO 6 N.m).

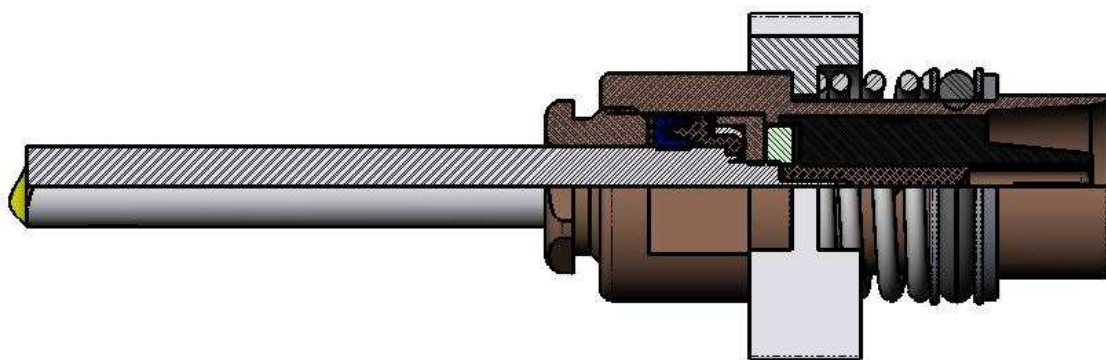

\*Picture above represents size 1 coaxial socket contact (620103) for display only.