		PRELIMINARY TECHNICAL DATA SHEET	MICT0400006	
Series NSX / EPX	SIZE 8 QUADRAX CONTACTS WIRING INSTRUCTIONS QUAD ETHERNET NF22Q100 CABLE		Issue May 05, 2015	Page 1 / 4

FOR NON-ENVIRONMENTAL QUADRAX ONLY / ALL SERIES:

1/ Slide the heat shrinkable sleeve over the cable.



FOR ENVIRONMENTAL QUADRAX ONLY / ALL SERIES:

1bis/ Slide the sealing boot over the cable.



FOR NON-ENVIRONMENTAL PIN QUADRAX ONLY / NSX SERIE ONLY:

1ter/ Slide alignment boot over the cable.

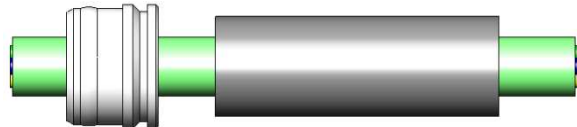

THE FOLLOWING STEPS ARE FOR ALL SERIES AND ALL STYLES OF QUADRAX:

2/ Strip the cable as illustrated: A= 25 mm (.787 inch):



3/ Comb the braid and cut rod fillers.
Cut the 4 inner conductors to length indicated: B= 21 mm (.630 inch)

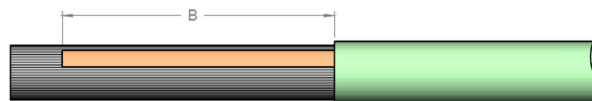

4/ Slide the shield crimp sleeve over the braid against the sheath end cut.
First, twist the braid end to facilitate the sliding of the shield crimp sleeve.



CREATION NAME : BRANJONNEAU DATE : March 17, 2015 APPR. : LEGENDRE				
	Mar. 25, 16	EPX Serie added	Moutault W.	Vieira D.
	May 05, 15	Strip dimensions updated. Added heat shrinkable sleeve	Branjonneau V.	Legendre T.
	ISSUE	REVISIONS	NAME	APPROVED

- 5/ Fold back the braid over the shield crimp sleeve.
Cut the braid and the 4 conductors as shown:
A= 13.5 mm (.531 inch)
B= 3.5 mm (.138 inch)
C= 4 mm (.157 inch)

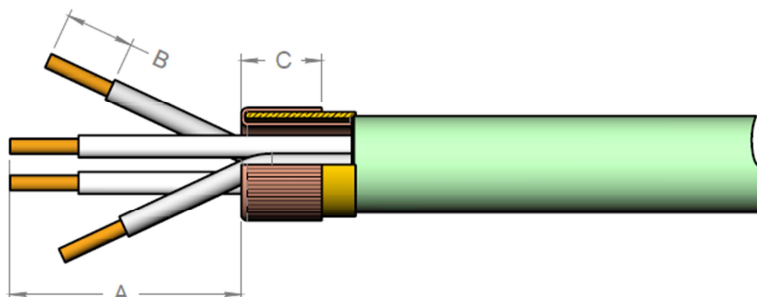

- 6/ Slide the center contacts on the conductors:
- 4 pin center contacts on the quadrax pin contact
 - 4 socket center contacts on the quadrax socket contact

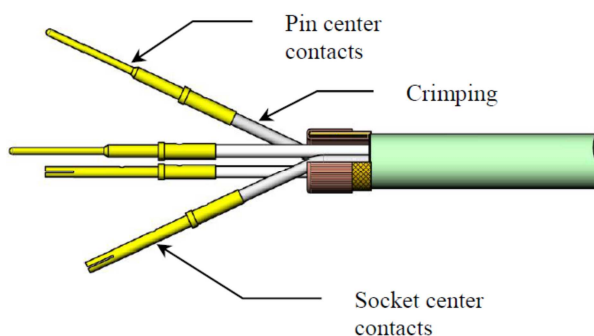

- 7/ Crimp the center contacts

Crimping tool : M22520/2-01 (RADIAL 282 281) selector 5
Positioner : DANIELS K 709 (RADIAL: 282 581 010)

- 8/ Put in place the 4 conductors into the slots of the spacer
Then, slide the insulator over the contacts making the polarizing keyways coincident

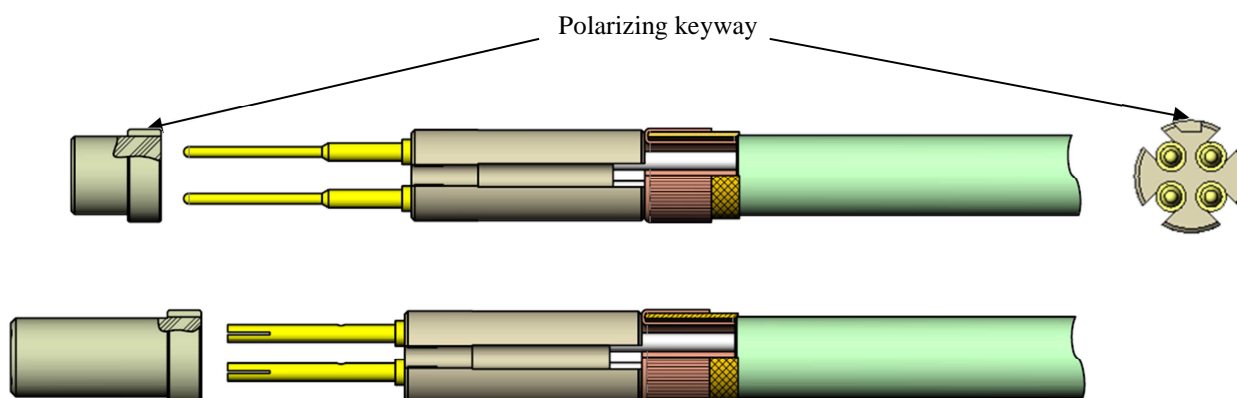

- 9/ The male and female outer contact bodies have an insulator polarizing key. The insulator and the spacer have a polarizing keyway. Then, introduce the sub-assembly into the outer contact body making the polarizing keys coincident.

FEMALE QUADRAX CONTACT

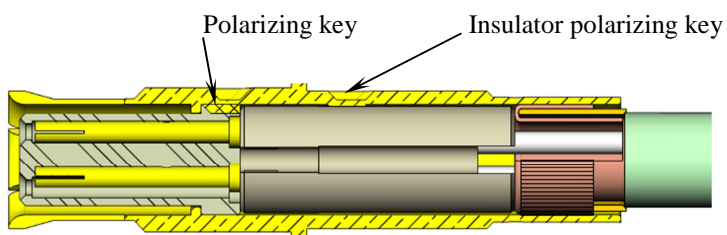

MALE QUADRAX CONTACT

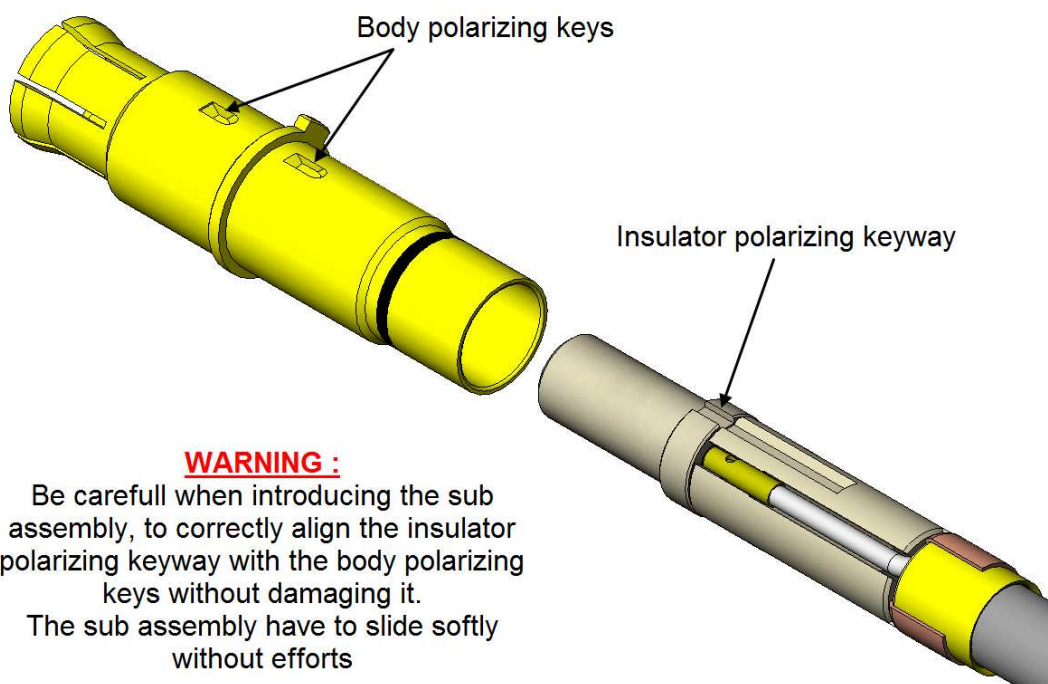
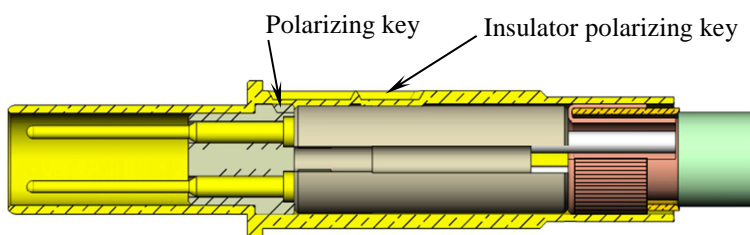

WARNING :

Be carefull when introducing the sub assembly, to correctly align the insulator polarizing keyway with the body polarizing keys without damaging it.
The sub assembly have to slide softly without efforts

10/ Push strongly on the cable while crimping to make sure that the inner parts are well mounted in the body.

Crimping tool: M22520/5-01 (RADIALl 282 293)
Die: M22520/5-45 (RADIALl 282 236)
Hex die closure B (.218 on flats)

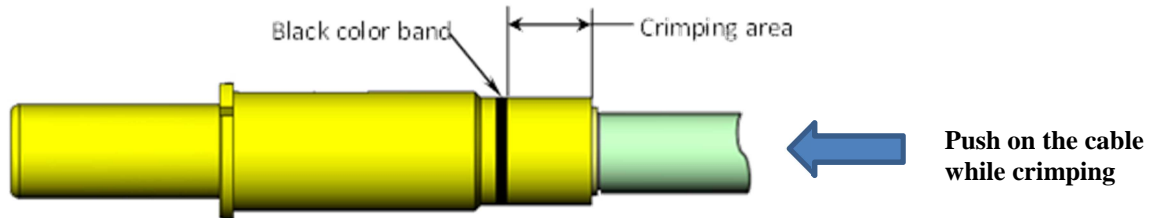

FOR NON-ENVIRONMENTAL QUADRAX ONLY / ALL SERIES:

11/ Slide the heat shrinkable sleeve on the crimping area (cover up to the black color band). Heat it.

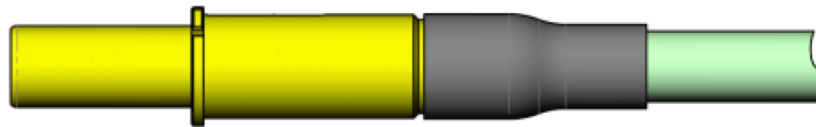

FOR ENVIRONMENTAL QUADRAX ONLY / ALL SERIES:

11bis/ Slide the sealing boot on the crimping area.

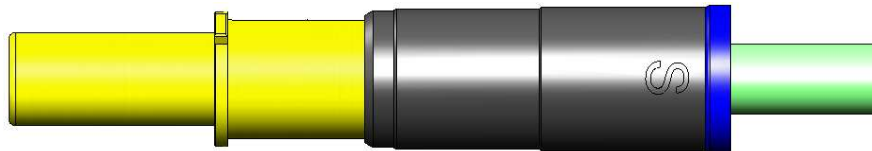

FOR NON-ENVIRONMENTAL PIN QUADRAX ONLY / NSX SERIE ONLY:

11ter/ Slide alignment boot and the heat shrinkable sleeve on the crimping area (cover up to the black color band). Heat it.

