

ASSEMBLY

Inserting the adaptor (identical to COAX #5)

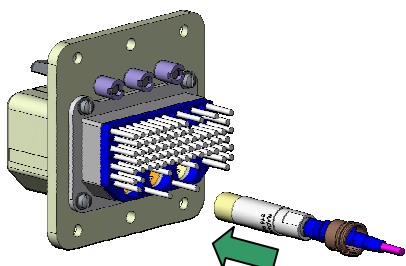

Inserting the adaptor by hand

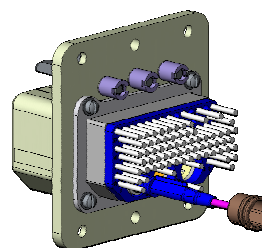

The set collar remains on the optical wire

Inserting the set collar (Be careful with cables surrounding the extraction tool)

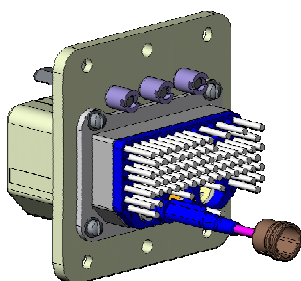

Position the tool around the set collar

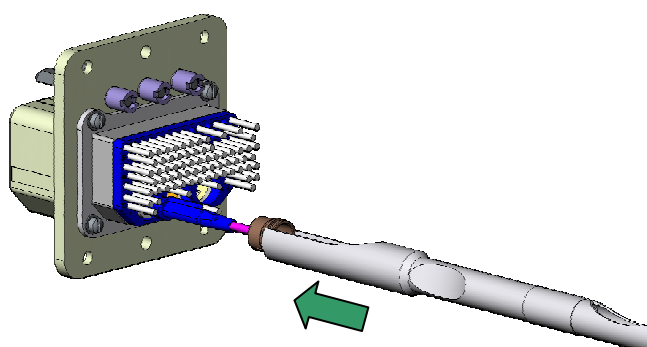

Inserting the set collar in the insert

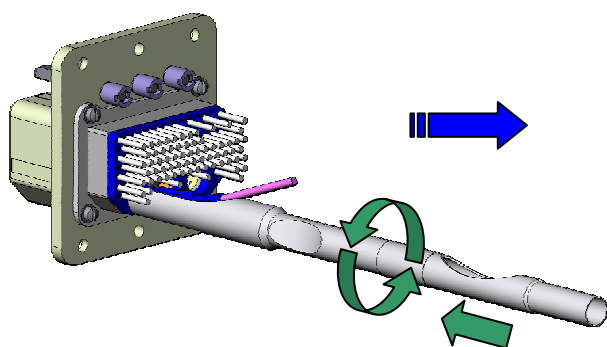
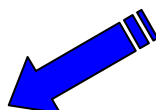

Push and turn the set collar using the tool to align the flats of the adaptor and the flats of the set collar.

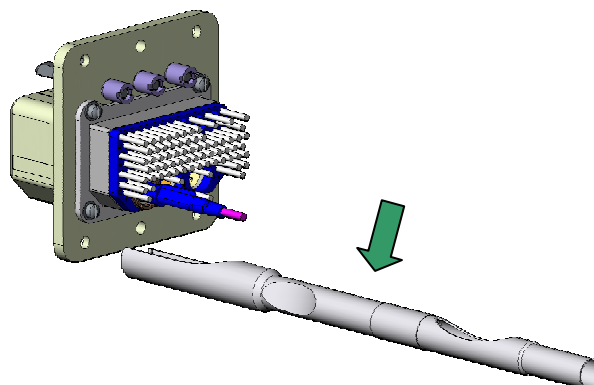

Remove the tool by sliding it off. The set collar is installed.

CREATION NAME : MOUTAULT DATE : Jan. 23, 2014 APPR. : DUPUIS				
	ISSUE	REVISIONS	NAME	APPROVED

DISASSEMBLY

Extracting the set collar (Be careful with cables surrounding the extraction tool)

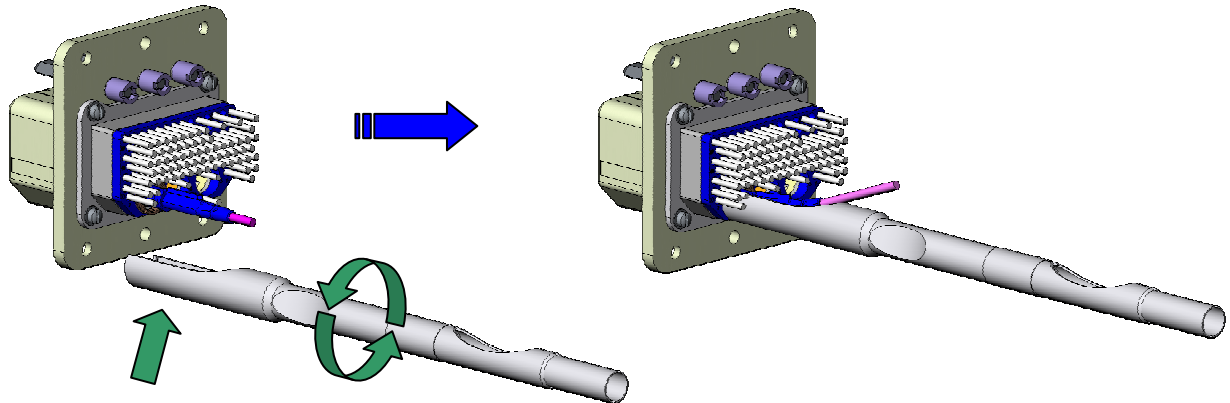

Insert the tool around the set collar by matching up the flats of the set collar and the flats of the tool and sliding it on.

The tool is positioned

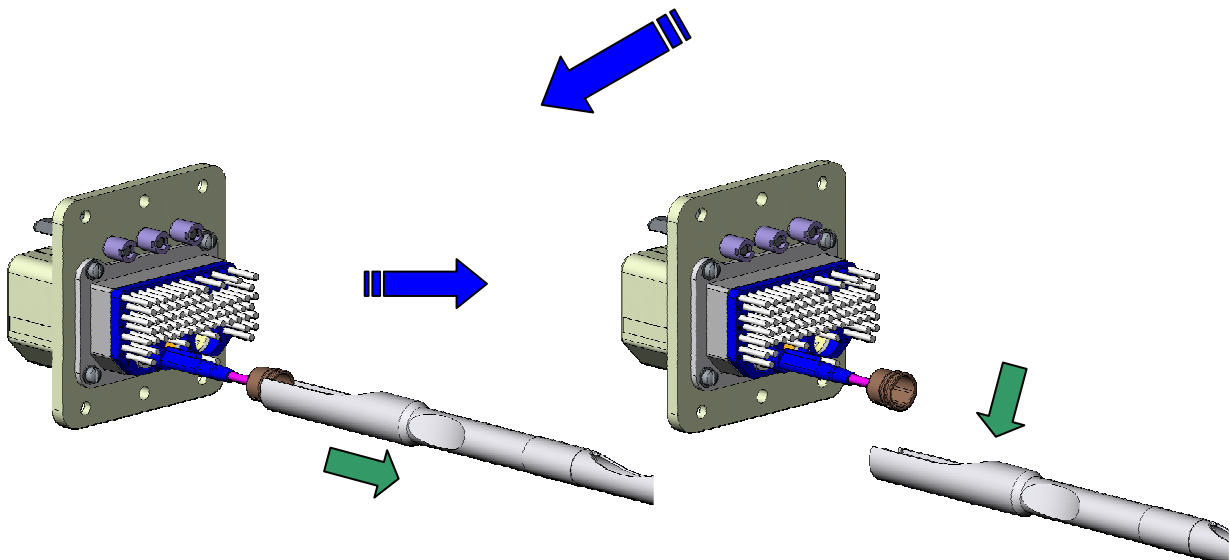

Pull to remove the set collar

Slide off the tool to remove it.
The collar remains on the optical wire

Use the other end of the 2 in 1 tool to extracting the adaptor



Extracting of the adaptor (identical COAX #5)

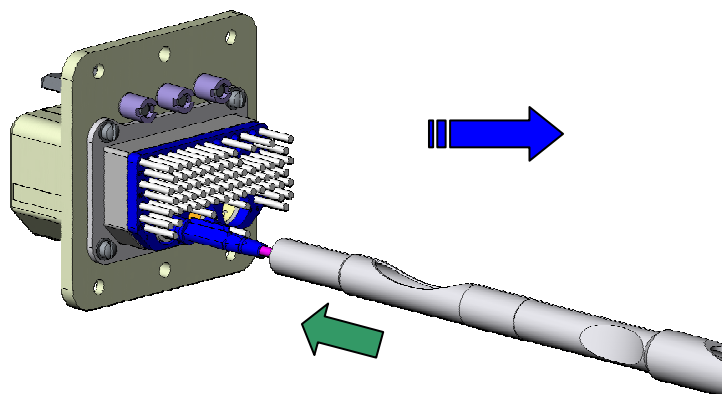

Insert the tool around the optical wire

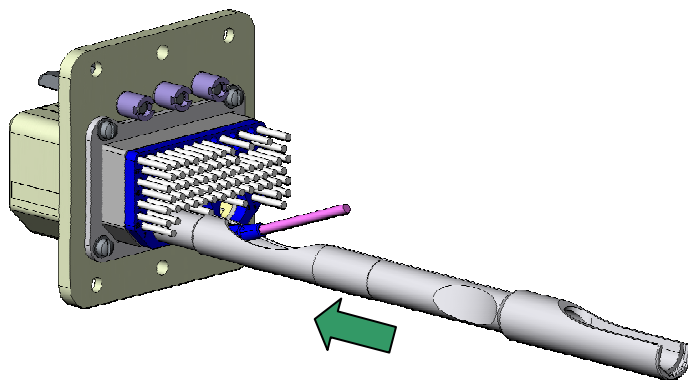

Push until the click (stop)

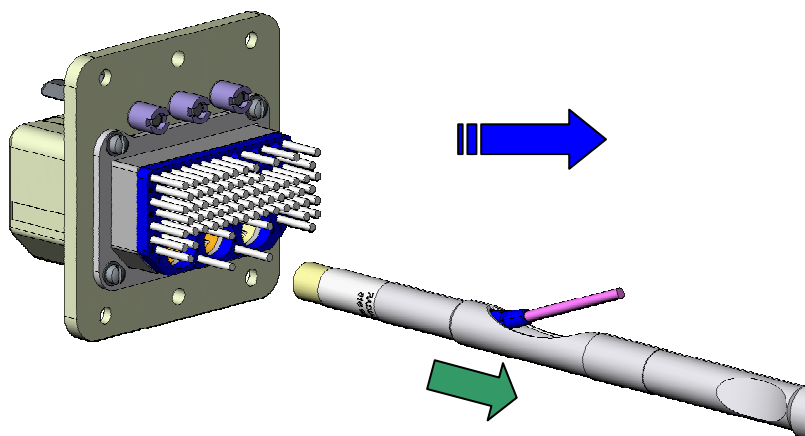
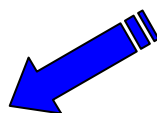

Pull on the tool by keeping
the optical wire

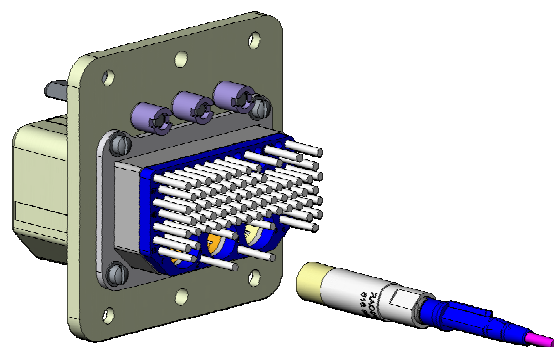

The adaptor is removed