

Series
EPXB

SIZE 16 CRIMP PIN CONTACT
WITH SIZE 14 CRIMP BARREL

Issue:
Nov. 02, 2012

Page
1/1

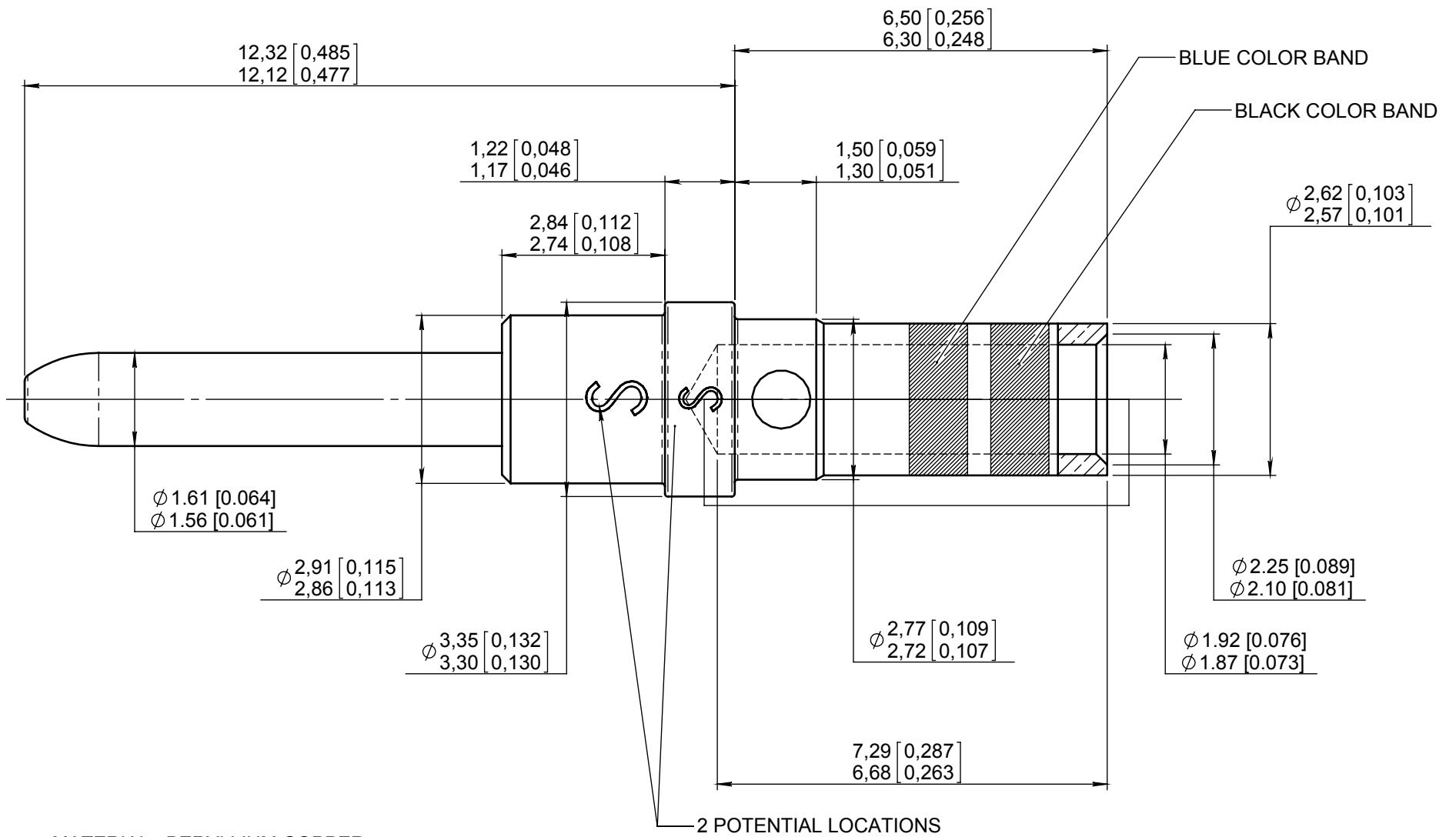

MATERIAL : BERYLLIUM COPPER.

FINISH : GOLD OVER NICKEL PLATED.

WIRING INSTRUCTIONS :
WIRES ACCOMODATED : AWG 14-16-18
WIRE MATERIAL: ANNEALED COPPER
MAX WIRE O.D. : 2,62 MAX (.103)
MAX STRANDED CONDUCTOR DIAMETER: 1.73 max (.068)
STRIP LENGHT : 6 (.236)

ELECTRICAL CHARACTERISTICS: MAX CURRENT AMPS: 13A FOR AWG 14-16

CRIMP CONTACT TENSILE REQUIREMENTS USING MIL SPEC TOOLING AND WIRE SPEC
M22520/1-01 14 GA. 70 LBF (31.15 daN)

CRIMPED CONTACTS WILL SHOW NO CRACK WHEN INSPECTED PER MIL-C-22520 AT 5X

RADIALL TOOLING RECOMMENDATION
CRIMPING TOOL : M22520/1-01 (RADIALL P/N : 282291)
SELECTOR POSITION : 6 FOR AWG 14
5 FOR AWG 16
5 FOR AWG 18

POSITIONER : M22520/1-02 (RADIALL 282 972)

INSERTION/EXTRACTION TOOL : M81969/14-03 (RADIALL 282 515)

DIMENSIONS : mm (inch are given for information only)

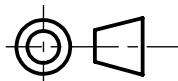

Estimated weight : 0,50 g

CREATION				
PEN: 2008-09-1855				
NOM: VIEIRA D.				
DATE: Nov. 02, 2012				
APPR.: LE GLOAHEC Y	Issue	Revisions	Name	Approved

617240200EN

RADIALL PROPRIETARY INFORMATION

This document contains proprietary information and such information shall not be disclosed to any third party for any purpose whatsoever or used for manufacturing purposes without prior written agreement from RADIALL. This information is given as an indication. In the continual goal to improve our products, we reserve the right to make any modifications judged necessary.

4112_9311